

Union_FT X FT

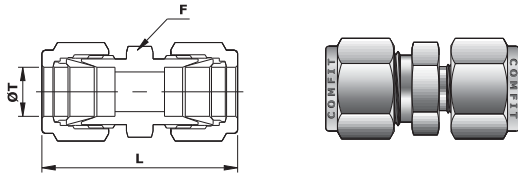

COMFIT PRODUCT CODE	TUBE OD (ØT)	LENGTH (L)	HEX (F)
	(Inches)		
2-CUD	1/8	1.40	7/16
4-CUD	1/4	1.61	1/2
5-CUD	5/16	1.69	9/16
6-CUD	3/8	1.77	5/8
8-CUD	1/2	2.02	7/8
12-CUD	3/4	2.11	1-1/16
16-CUD	1	2.55	1-3/8

Union_MT X MT

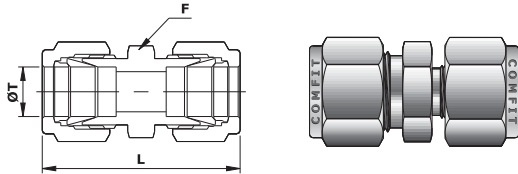

COMFIT PRODUCT CODE	TUBE OD (ØT)	LENGTH (L)	HEX (F)
	(mm)		
2M-CUD	2	35.6	12
3M-CUD	3	35.3	12
4M-CUD	4	37.3	12
6M-CUD	6	41.0	14
8M-CUD	8	43.2	15
10M-CUD	10	46.2	19
12M-CUD	12	51.2	22
15M-CUD	15	52.0	25
16M-CUD	16	52.0	25
25M-CUD	25	65.0	35

Reducer Union_FT X FT

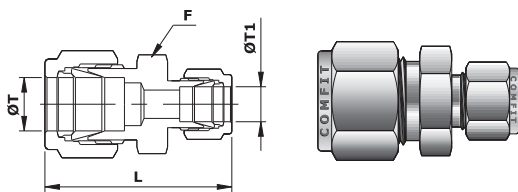

COMFIT PRODUCT CODE	TUBE OD (ØT)	TUBE OD (ØT1)	LENGTH (L)	HEX (F)
	(Inches)			
2-CRUD-1	1/8	1/16	1.22	7/16
4-CRUD-1	1/4	1/16	1.35	1/2
4-CRUD-2	1/4	1/8	1.52	1/2
4-CRUD-3	1/4	3/16	1.55	1/2
5-CRUD-2	5/16	1/8	1.56	9/16
5-CRUD-4	5/16	1/4	1.66	9/16
6-CRUD-1	3/8	1/16	1.44	5/8
6-CRUD-2	3/8	1/8	1.61	5/8
6-CRUD-4	3/8	1/4	1.70	5/8
6-CRUD-5	3/8	5/16	1.74	5/8
8-CRUD-2	1/2	1/8	1.78	7/8
8-CRUD-4	1/2	1/4	1.85	7/8
8-CRUD-6	1/2	3/8	1.91	7/8
12-CRUD-4	3/4	1/4	1.94	1-1/16
12-CRUD-6	3/4	3/8	2.00	1-1/16
12-CRUD-8	3/4	1/2	2.11	1-1/16
12-CRUD-10	3/4	5/8	2.11	1-1/16
16-CRUD-8	1	1/2	2.38	1-3/8
16-CRUD-12	1	3/4	2.38	1-3/8

Reducer Union_MT X MT

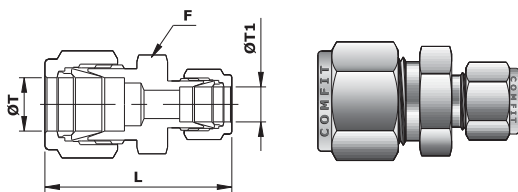

COMFIT PRODUCT CODE	TUBE OD (ØT)	TUBE OD (ØT1)	LENGTH (L)	HEX (F)
	(mm)			
3M-CRUD-2M	3	2	35.3	12
6M-CRUD-2M	6	2	38.6	14
6M-CRUD-3M	6	3	38.6	14
6M-CRUD-4M	6	4	39.4	14
8M-CRUD-6M	8	6	42.3	16
10M-CRUD-6M	10	6	44.5	19
10M-CRUD-8M	10	8	45.1	19
12M-CRUD-6M	12	6	47.0	22
12M-CRUD-8M	12	8	47.8	22
12M-CRUD-10M	12	10	48.7	22
16M-CRUD-10M	16	10	49.5	25
16M-CRUD-12M	16	12	52.0	25
25M-CRUD-18M	25	18	61.0	35
25M-CRUD-25M	25	25	62.3	35

Bulkhead Union_FT X FT

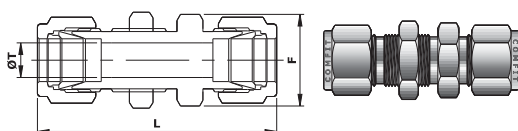

COMFIT PRODUCT CODE	TUBE OD (ØT)	LENGTH (L)	HEX (F)
	(Inches)		
2-CBUD	1/8	2.02	1/2
4-CBUD	1/4	2.27	5/8
5-CBUD	5/16	2.39	11/16
6-CBUD	3/8	2.45	3/4
8-CBUD	1/2	2.80	1
12-CBUD	3/4	3.11	1-3/16
16-CBUD	1	3.77	1-5/8

DIMENSIONS FOR REFERENCE ONLY, SUBJECT TO CHANGE.



Bulkhead Union_MT X MT

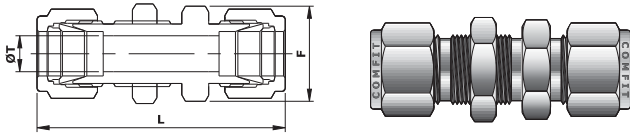

COMFIT PRODUCT CODE	TUBE OD (ØT)	LENGTH (L)	HEX (F)
	(mm)		
3M-CBUD	3	51.3	14
4M-CBUD	4	53.6	14
6M-CBUD	6	57.7	16
8M-CBUD	8	61.0	19
10M-CBUD	10	63.7	22
12M-CBUD	12	71.0	25
15M-CBUD	15	72.5	27
16M-CBUD	16	72.5	27
25M-CBUD	25	95.8	41

Bulkhead Reducer Union_FT X FT

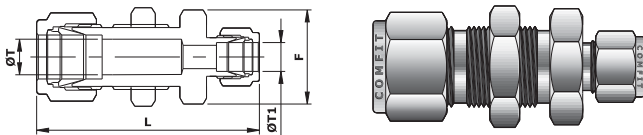

COMFIT PRODUCT CODE	TUBE OD (ØT)	TUBE OD (ØT1)	LENGTH (L)	HEX (F)
	(Inches)			
4-CBRUD-2	1/4	1/8	2.17	5/8
6-CBRUD-4	3/8	1/4	2.39	3/4
8-CBRUD-4	1/2	1/4	2.63	1

Bulkhead Reducer Union_MT X MT

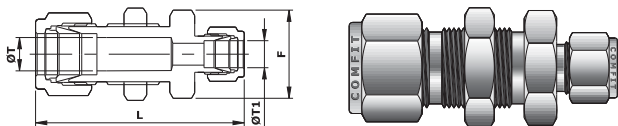

COMFIT PRODUCT CODE	TUBE OD (ØT)	TUBE OD (ØT1)	LENGTH (L)	HEX (F)
	(mm)			
12M-CBRUD-10M	12	10	68	25

Male Elbow_FT X NPT(M)

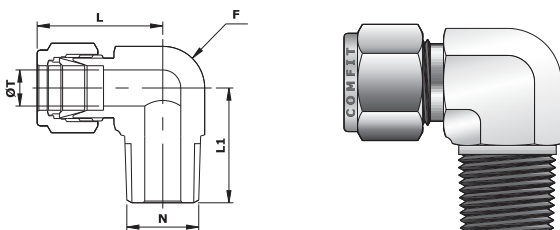

COMFIT PRODUCT CODE	TUBE OD (ØT)	NPT MALE PIPE (N)	LENGTH (L)	LENGTH (L1)	HEX (F)
	(Inch)				
2-CMED-1N	1/8	1/16	0.93	0.70	7/16
2-CMED-2N	1/8	1/8	0.93	0.70	7/16
2-CMED-4N	1/8	1/4	0.97	0.92	9/16
4-CMED-1N	1/4	1/16	1.06	0.74	1/2
4-CMED-2N	1/4	1/8	1.06	0.74	1/2
4-CMED-4N	1/4	1/4	1.06	0.92	9/16
4-CMED-6N	1/4	3/8	1.17	1.03	11/16
4-CMED-8N	1/4	1/2	1.25	1.30	7/8
5-CMED-2N	5/16	1/8	1.13	0.78	5/8
5-CMED-4N	5/16	1/4	1.13	0.96	5/8
5-CMED-6N	5/16	3/8	1.20	1.03	11/16
6-CMED-2N	3/8	1/8	1.20	0.82	5/8
6-CMED-4N	3/8	1/4	1.20	1.00	5/8
6-CMED-6N	3/8	3/8	1.23	1.03	11/16
6-CMED-8N	3/8	1/2	1.31	1.30	7/8
6-CMED-12N	3/8	3/4	1.46	1.45	1-1/16
8-CMED-4N	1/2	1/4	1.42	1.11	13/16
8-CMED-6N	1/2	3/8	1.42	1.11	13/16
8-CMED-8N	1/2	1/2	1.42	1.30	7/8
8-CMED-12N	1/2	3/4	1.57	1.45	1-1/16
12-CMED-8N	3/4	1/2	1.57	1.45	1-1/16
12-CMED-12N	3/4	3/4	1.57	1.45	1-1/16
16-CMED-12N	1	3/4	1.93	1.64	1-3/8
16-CMED-16N	1	1	1.93	1.83	1-3/8

DIMENSIONS FOR REFERENCE ONLY, SUBJECT TO CHANGE.