

FLANGE CONNECTOR

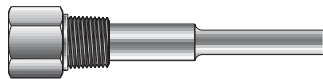

THERMOWELLS

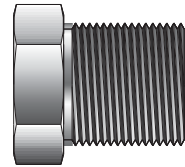

VENT PROTECTORS

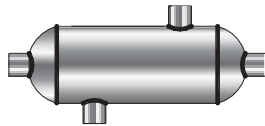

CONDANSATE POT

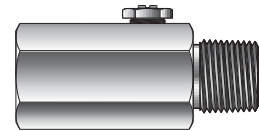

GAUGE SNUBBER

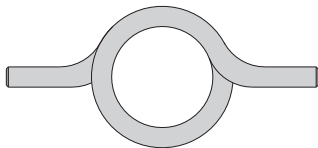

SYPHON

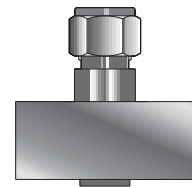

KIDNEY FLANGE



MINI SYPHON

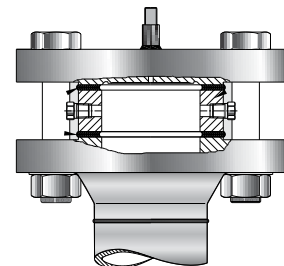

FLUSH RING



CONTENTS

- CONTENTS for Instrument Accessories End.....pg. 53

Connectors



Flange Connector (ANSI, DIN, JIS, FLANGES)

- Fractional & Metric Tube x Pressure Class..... pg. 54

Thermowells

Introduction.....pg.55

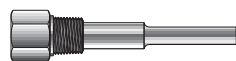

Threaded Type (Standard)

- Standard Thermowell - CST..... pg.56
- Heavy Duty Thermowell CHT.....pg.56

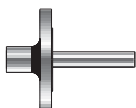

Flanged Thermowell

- Standard Thermowell CSTF.....pg.57



SANITARY WELD-IN TYPE

- Standard Thermowell - CSYWTpg.57

ORDERING CODES.....pg.58

Others

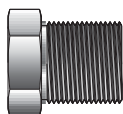

Vent Protector

- NPT (M).....pg.59

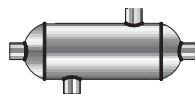

Condensate Pot

- Conn : NPT, SW, BW.....pg.59

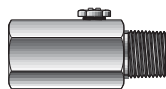

Gauge Snubber

- NPT(F) x NPT(M).....pg.59

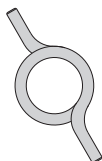

Syphon

- NPT(M) - with 180°
- 90°, 270°, 360°.....pg.60

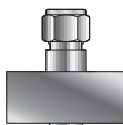

Kidney Flange

- 1/2"NPT (M), NPT (F), ODT.....pg 60



MINI SYPHON

- 1/2"NPT (M), NPT (F),pg 60

Flush Ring

- 2" to 4", 150# - 2500#.....pg. 61

Tee Filter

- Tee Filter.....pg. 62
- Sample Cylinder.....pg. 61

Orifice Plate

- Segmental.....pg. 63
- Quadrant Edge.....pg. 63
- Restriction.....pg. 63
- RTJ.....pg. 63
- Multistage Restriction.....pg. 63
- Segmental orifice plate.....pg. 64

FLANGE CONNECTOR (ANSI/DIN/JIS FLANGES) FRACTIONAL & METRIC TUBE X PRESSURE CLASS

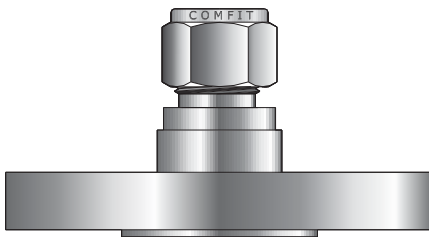
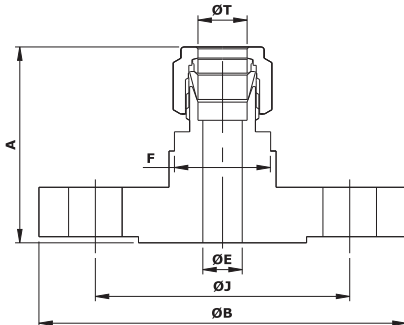

ANSI Flanges

COMFIT PRODUCT CODE	TUBE OD (ØT)	ANSI Flange NPS	Class	A	B	D	E	F	H	J
	(Inch)									
4-CFCD-F8-ANSI-150	1/4	1/2	150	1.61	3.50	0.60	0.19	13/16	1.32	2.38
6-CFCD-F8-ANSI-300	3/8	1/2	300	1.79	3.75	0.66	0.28	13/16	1.50	2.62
8-CFCD-F8-ANSI-150	1/2	1/2	150	1.78	3.50	0.90	0.41	13/16	1.38	2.38
8-CFCD-F16-ANSI-150	1/2	1	150	1.90	4.25	0.90	0.41	13/16	1.50	3.12
8-CFCD-F8-ANSI-150	1/2	2	150	2.09	6.00	0.90	0.41	13/16	1.69	4.75
12-CFCD-F16-ANSI-150	3/4	1	150	1.98	4.25	0.96	0.62	1-1/4	1.58	3.12
16-CFCD-F16-ANSI-150	1	1	150	2.38	4.25	1.23	0.88	1-3/8	1.90	3.12

DIN Flanges, Pressure Class PN 40

COMFIT PRODUCT CODE	TUBE OD (ØT)	JIS Flange DN	A	B	D	E	F	H	J
	(Inch)								
6M-CFCD-F25M-DIN-40	6	25	47.5	115.0	15.3	4.8	20	40.1	85.0
12M-CFCD-F15M-DIN-40	12	15	48.5	95.0	22.8	9.5	20	38.4	65.0
12M-CFCD-F25M-DIN-40	12	25	50.5	115.0	22.8	9.5	20	40.4	85.0
12M-CFCD-F50M-DIN-40	12	50	55.3	165.0	22.8	9.5	20	45.2	125.0
18M-CFCD-F15M-DIN-40	18	15	51.8	95.0	24.4	15.1	32	41.7	65.0
18M-CFCD-F25M-DIN-40	18	25	53.8	115.0	24.4	15.1	32	43.7	85.0
25M-CFCD-F25M-DIN-401	25	25	64.0	115.0	31.3	21.8	35	51.8	85.0

10K-JIS Flanges, Pressure Class

COMFIT PRODUCT CODE	TUBE OD (ØT)	JIS Flange DN	A	B	D	E	F	H	J	
	(Inch)									
4-CFCD-F15M-JIS-10K	1/4	15	1.66	3.74	0.60	0.19	13/16	1.37	2.76	
6-CFCD-F15M-JIS-10K	3/8	15	1.72	3.74	0.66	0.28	13/16	1.43	2.76	
8-CFCD-F15M-JIS-10K	1/2	15	1.83	3.74	0.90	0.41	13/16	1.43	2.76	
12-CFCD-F15M-JIS-10K	3/4	15	1.91	3.74	0.96	0.62	1-1/4	1.51	2.76	
16-CFCD-F25M-JIS-10K	1	25	2.40	4.92	1.23	0.88	1-3/8	1.92	3.54	
(mm)										
12M-CFCD-F15M-JIS-10K	12	15	46.5	95.0	22.8	9.5	20	36.3	70.0	
18M-CFCD-F15M-JIS-10K	18	15	48.5	95.0	24.4	15.1	32	38.4	70.0	
25M-CFCD-F25M-JIS-10K	25	25	61.0	125.0	31.3	21.8	35	48.8	90.0	

Vent Protector__NPT(M)

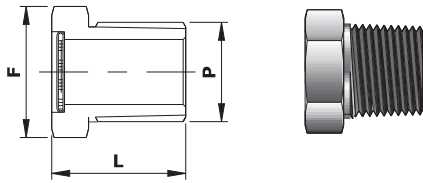

COMFIT PRODUCT CODE	NPT Thread Size (P)	LENGTH (L)	HEX (F)
	(Inch)		
4N-CVPD	1/4	0.78	9/16
6N-CVPD	3/8	0.81	11/16
8N-CVPD	1/2	1.03	7/8
12N-CVPD	3/4	1.06	1-1/16
16N-CVPD	1	1.31	1-3/8

CONDENSATE POT

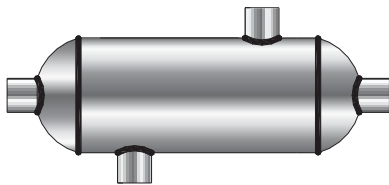

FEATURES

- Body, fabricated from seamless pipe and weld caps.
- All pipe connections are 3000# half couplings & mounted with plastic caps.
- All welding as per ASME SEC. IX & butt weld joints & fillet weld will be D.P. tested.
- All material will have mother test certificates.
- Piping code compliance ASME B31.1 and PED category I, Module - A.
- Heat code traceability.
- Radiography test as per requirement

TYPES

INLET	DRAIN	OUTLET	COMFIT PRODUCT CODE
1/2"	1/4"	1/2"	CAHDB - 8F - 4F - 8F
3/4"	1/4"	3/4"	CAHDB - 12F - 4F - 12F
1/2"	1/2"	1/2"	CAHDB - 8F - 8F - 8F
3/4"	1/2"	3/4"	CAHDB - 12F - 8F - 12F

GAUGE SNUBBER MODEL : CGS

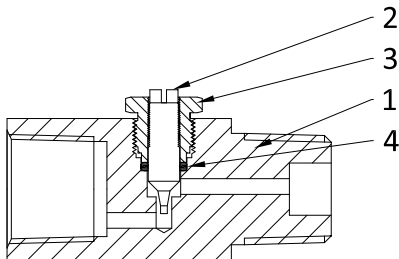

SPECIFICATIONS

- Size - 1/4", 3/8", 1/2"
- End connection - NPT
- Material - SS 316 & BRASS
- Pressure Rating :
SS 316 - size 1/4", 1/2" - 5000 psig
Brass - size 1/4", 1/2" - 3000 psig

TECHNICAL SPECIFICATIONS

- Pipe Size : 2", 3", 4", 6"
- Length : 8", 10", 12" & larger.
- Body Pipe : 40, 60, 160, XXS (Schedule Pipe) Seamless Pipe.
- Material : SS 316, SS 304, C.S., ASTM A 106 Gr. B
- Optional Sour Gas service valves are available confirming to NACE Std. MR - 01 - 75
- NPT thread as per ANSI B2.1
- Socketweld as per ANSI B16.11
- Buttweld as per ANSI B16.9
- All condensate are 100% Factory tested prior to shipment.
- Hydrostatic Shell Test is performed at 1.5 times the working pressure.

FEATURES & BENEFITS

- Pressure Pulsation Dampener
- Protects pressure gauges against pressure perturbation, surges, and fluid hammers.
- Can isolate the gauge for service or replacement.
- Available in both Stainless Steel and Brass in 1/4", and 1/2" NPT connection sizes.
- Fine thread adjustable valve allows user to fine tune harmful harmonic vibration from fluid systems
- Simple . Clever . Economical
- Most economical "life insurance" for instrumentation reliability.
- Precision ball affords shock protection during pressure spikes or fluid hammer conditions.

Sr. No.	Description	Qty.	Material
1	Body	1	SS 316
2	Stem	1	SS 316
3	Gland	1	SS 316
4	Packing	1	VITON

VALVE SIZE		COMFIT PRODUCT CODE	C	D
INLET `A`	OUTLET `B`			
1/4" NPT (F) X 18TPI	1/4" NPT (F) X 18TPI	4NM - CGS - NF	52	22
1/4" NPT (F) X 18TPI	1/4" NPT (F) X 18TPI	4NM - CGS - NF	52	22
1/2" NPT (F) X 14TPI	1/2" NPT (F) X 14TPI	8NM - CGS - NF	62	32
1/2" NPT (F) X 14TPI	G1/2" NPT (F) X 14TPI	8NM - CGS - NF	62	32

DIMENSIONS FOR REFERENCE ONLY, SUBJECT TO CHANGE.

SYPHON MODEL : CS

DESCRIPTION:

- The Syphon Tube is connected between the pressure gauge & process in applications where high temperature vapours or fluids are present or temperature above 65 Deg C for eg. steam. It acts as a cooling coil and protects the gauge from high temperature vapours, also siphons help in dissipating heat.

SPECIFICATIONS:

- Size - 1/4" & 1/2"
- End connection - NPT, Socket weld, Butt weld
- Coil style - 180%*d*, 90%*d*, 270%*d*, 360%*d*
- Working Pressure - upto 3000 psig related to pipe thickness.
- Material - SS 316, SS 304, C.S., Brass (Seamless & Welded pipe)

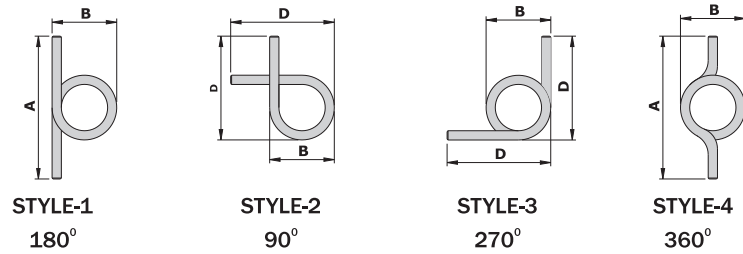

SIZE	COMFIT PRODUCT CODE	A	B	C	D
1/4" NPT(M)x18TPI	4NM - CS	98	64	49.0	81.5
1/2" NPT(M)x14TPI	8NM - CS	229	114	114.5	171.5
1/4" NPT(M)x18TPI	4NM - CS	98	64	49.0	81.5
1/2" NPT(M)x14TPI	8NM - CS	229	114	114.5	171.5

KIDNEY FLANGE MODEL : CKF

DESCRIPTION:

- Oval flange connection for simple and safe from process measurement impulse instrument or manifold.

SPECIFICATIONS:

- 1) Size : 1/2"
- 2) Connections : ODT, NPT(F), NPT(M), Blind, Butt weld (pipe sch 40,80,160), Socket weld (pipe sch 40,80,160)
- 3) Working Pressure - 6000Psig (413 barg)
- 4) Material - SS 316
- 5) Bolting - High tensile carbon steel bolts for bolting 7/16" UNF x 40 long
- 6) Sealing - PTFE std., graphite optional.

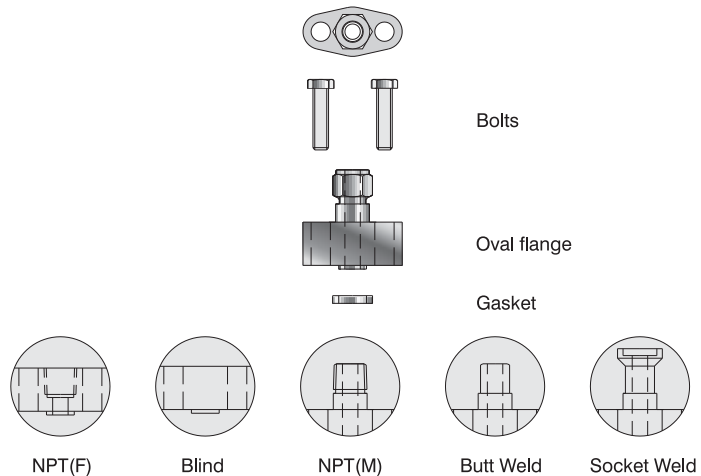

MINI SYPHON

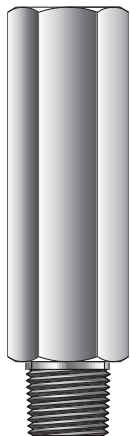

DESCRIPTION:

Mini syphons are mainly used to protect pressure gauge / pressure transducer from harmful steam, hot vapors and liquids. It also reduce gauge whip and vibration. When the mini-siphon is first installed, it is recommended to be filled with water or any other suitable separating liquid. The position of mini syphon must be vertical only.

FEATURES:

Size: 1/2" X 1/2", 3/4" X 1/2"
 End connection: NPT, BSPP, BSPT
 Working pressure : 6000psig(413bar)
 Material: SS316, SS304, CARBON STEEL, Monel 400, Hastelloy C276, Duplex
 Orifice : 4.0mm

PRODUCT CODE	INLET	OUTLET	ORIFICE
8NM-CPMS-8NF	1/2" NPTM	1/2" NPTF	4.0